

EQUIPMENT				
ID #	DESCRIPTION	MANUFACTURER	W x D x H	NOTES
1	Reach-In Freezer 1 Door	True, T-19F	27" x 24-1/2" x 78-3/8"	
2	Cash Register	CRS Inc., ER-940	15-3/4" x 11-13/16" x 17-3/4"	
3	Thermal Dispenser	Fetco, L3D-10	8" x 12" x 21-1/2"	
4	Portion Control Coffee Grinder	Fetco, GR 2.2	9-1/4" x 15-1/2" x 28-1/2"	2-Hopper
5	Twin Drip Coffee Air-Pot Brewer	Fetco, CBS-2042e	19" x 17-1/2" x 34-1/4"	
6	Table, Stainless	Advance Tabco, TFMS-150	15" x 30" x 35-1/2"	w/ Open Base
7	Natural Gas Range w/ 4 Open Burners/ 24" Griddle & Oven	Vulcan, 48S-4B24GN	48" x 53-1/2" x 58"	
8	Manual Gas Griddle	Star-Max, 615MF	15" x 29" x 15-1/2"	
9	Electric Fryer	Eagle-RedHots, EF10-120	12" x 19-1/4" x 10-5/8"	
10	Chef Base Drawered Refrigerator	True, TRCB-36	36-3/8" x 32-1/8" x 20-3/8"	
11	Exhaust Hood	MFG/ Model To Be Determined	9' x 4'	w/ Exhaust Fan, Duct Work, Make-Up Air, & Fire Suppression
12	Table, Stainless	Advance Tabco, FT-3015	15" x 30" x 35-1/2"	w/ Undershelf
13	Sandwich Mega Top Refrigerator	Hoshizaki, CRMR27-12M	27" x 30" x 45-1/2"	1 w/ Reverse Door
14	Steam Table / Food Warmer	Supreme Metal, Triumph- SW-3E-120	47-1/2" x 30-5/8" x 34-1/8"	
15	Hand Sink, wall mount	Advance Tabco, 7-PS-EC-X	17" x 15-1/4" x 13"	
16	3 Gallon Iced Tea Brewer	Bunn, TB3	11-5/8" x 22" x 34"	
17	Drop-In Sink	Advance Tabco, DI-1-10	17" x 15" x 5"	
18	Beverage Blender	Blendtec Stealth	8-5/8" x 9" x 17-3/8"	
19	Undercounter Refrigerator	Hoshizaki, CRMR27	27" x 30" x 33-1/2"	
20	3 Gallon Iced Tea Dispenser	Bunn, TDS3	9.8" x 12.8" x 19"	
21	Soft Drink Dispenser Drop-in 4 Core	Manitowoc, CF-1522	15" x 22" x 22-3/8"	
22	Ice Cube Maker w/ Holding Bin	Hoshizaki, KM-320MAH w/ B-300	22" x 32-1/2" x 46"	
23	Storage Rack	Metro, Super Erecta EZ1848-BR4	18" x 48" x 74-1/2"	
24	Walk-In Refrigerator	Kolpak Polar-Pak	Ext. Dim. 5'-10" x 5'-10"	4" Walls 26" Door
25	Storage Rack	Metro, Metroseal EZ1860NK3-4	18" x 60" x 74-1/2"	
26	Storage Rack, Clean Wares	Metro, Metroseal 1824NK3	24" x 18"	4 Posts 74PK3 74-5/8"
27	3 Compartment Ware Washing Sink 2 Drainboards & PreWash Sprayer	Regency, 600S31717218	91" x 22-1/2" x 44-3/4"	
28	Floor Mop Sink, Floor	Advance Tabco, 9-OP-20	25" x 21" x 10"	
29	Prep Table w/ sink	Advance Tabco KMS-244, Advance Tabco, TA-11J	14" x 16" x 12" Sink Size	w/ 4' x 2' Table
30	Storage Cabinet	Custom Work	4'-10" x 24" x 72"	
31	Employee Lockers	Kelmax, LMXEL6	12" x 12" x 72"	Bolted To Wall
32	Microwave Oven	Amana, RCS10MPA	21.75 x 20.25 x 14.25	
33	Microwave Shelf	Advance Tabco, MS-24-24	24" x 24" x 12"	
35	Countertop 3 Cup Dispenser w/ Lid & Condiment Organizer	Dispence-Rite, STL-SL-3BT	8-1/2" x 24" x 29-1/4"	
36	Cup & Lid Organizer	Cal-Mil, 378	8-1/4" x 8-1/4" x 18"	
37	Portable Foodwarmer	Glo-Ray, GRFF	12" x 24" x 16-20"	
51	Trash Can	Rubbermaid, "Slim Jim" 23 gal.	11" x 20" x 30"	
52	Waste Basket	Rubbermaid, 28 qt.	14-3/8" x 10-1/4" x 15"	
53	Bag-in-Box Flex-Rack & Pump, Carbonator or CO2 Canister	Manitowoc, IC 43206	28" Wide	1 Shelf
54	Electrical Panel			
55	Water Filtration System			

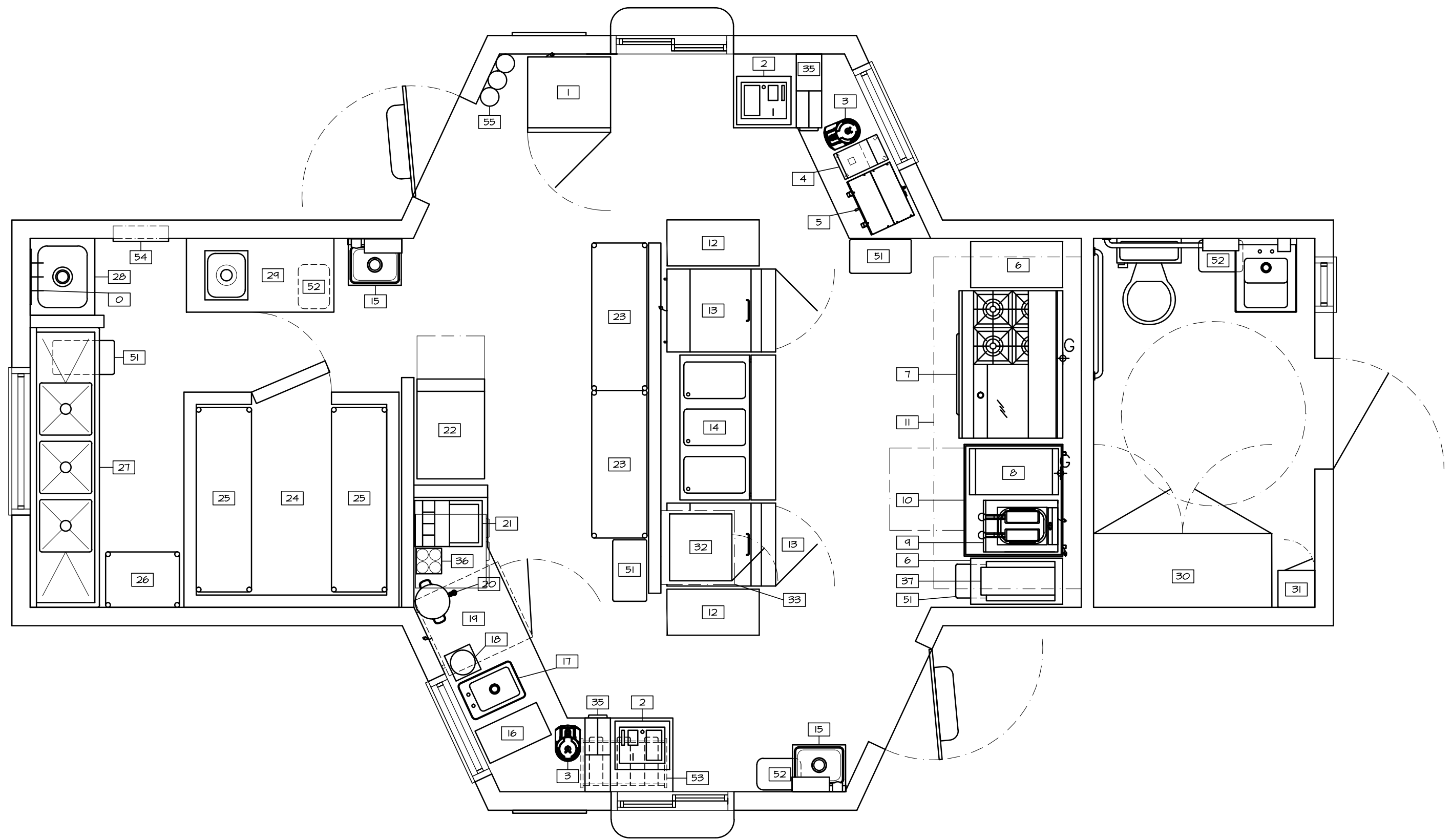

GENERAL NOTES:

- IF BUREAUCRATIC CODES DIFFER FROM WHAT IS SHOWN ON THIS DRAWING, CODES SHALL TAKE PRECEDENCE.
- WHERE EVER WALL MOUNTED SHELVES ARE TO BE ATTACHED TO WALLS, A 3/4" PIECE OF PLYWOOD OR OSB SHOULD BE INSET INTO WALL STUDS UNDER THE FINISHED WALL SURFACE TO PROVIDE SECURE ANCHOR FOR SHELF MOUNTINGS. INSET PLYWOOD OR OSB SHOULD BE 24" WIDE, WITH 4" EXTENDING ABOVE THE INDICATED HEIGHT OF SHELF MOUNT, AND THE REMAINING 20" BELOW THAT HEIGHT. LENGTH OF INSET SHOULD EXTEND 6" BEYOND EACH END OF THE SHELF. BE AWARE THAT THESE SHELVES MAY CARRY SIGNIFICANT WEIGHT.
- PROJECT ARCHITECT TO MAKE ALL DECISIONS RELATED TO:
 - GENERAL AREA LIGHTING
 - HVAC
 - LIGHTED SIGNS
 - GENERAL PURPOSE CONVENIENCE OUTLETS
 - BATHROOM FIXTURES
 - BUILDING CONSTRUCTION SPECIFICATIONS, MATERIALS, ETC.
- ALL EQUIPMENT & FIXTURE DIMENSIONS, ELECTRICAL SPECIFICATIONS, AND PLUMBING SPECIFICATIONS ARE BASED UPON THE EQUIPMENT SPECIFIED ON THESE DRAWINGS. IF EQUIPMENT MAKES/MODELS CHANGE, BE SURE TO ADJUST ACCORDINGLY ON ALL DRAWINGS.

Disclaimer

This drawing been created for the purpose of suggesting equipment placement to promote efficient operational flow. It may pass all codes & requirements for your local / state bureaucracies, however, the creator of this drawing cannot, and is not, guaranteeing that it will. Different cities / counties / states may have specific requirements which may not be addressed on this drawing. It is your responsibility to make sure that the features on this drawing are acceptable with your local bureaucracies before beginning construction. If codes require features different than what has been indicated on this drawing, codes shall take precedence over this drawing. This drawing is intended to be a rough planning guide for your architect &/or construction professional. Ed Arvidson shall be held harmless from any expenses / damages incurred as a result of information on this drawing.

TACO DRIVE THRU		
SCALE: 3/8"=1'-0"	APPROVED BY:	DRAWN BY: GXB
DATE:	For:	REVISION
EQUIPMENT ID		
E & C Consulting (541) 408-8626		DRAWING NUMBER 1 of 7